

IP/NETWORK CAMERA SURGE PROTECTION

SecureLinx Protectors:

- | | |
|-----------------------|-------------------|
| (1) MSL-CAT5-LAN-RJ45 | (5) MSL-CAT5-24V |
| (2) MSL-CAT5-POE-RJ45 | (6) MSL-CAT6-24V |
| (3) MSL-CAT6-LAN | (7) MSL-24V-POWER |
| (4) MSL-CAT6-POE | (8) DL1200-CAT5 |

- Ground
- Power - 2 conductor outdoor rated (24VAC)
- Ethernet over CAT5e or CAT6

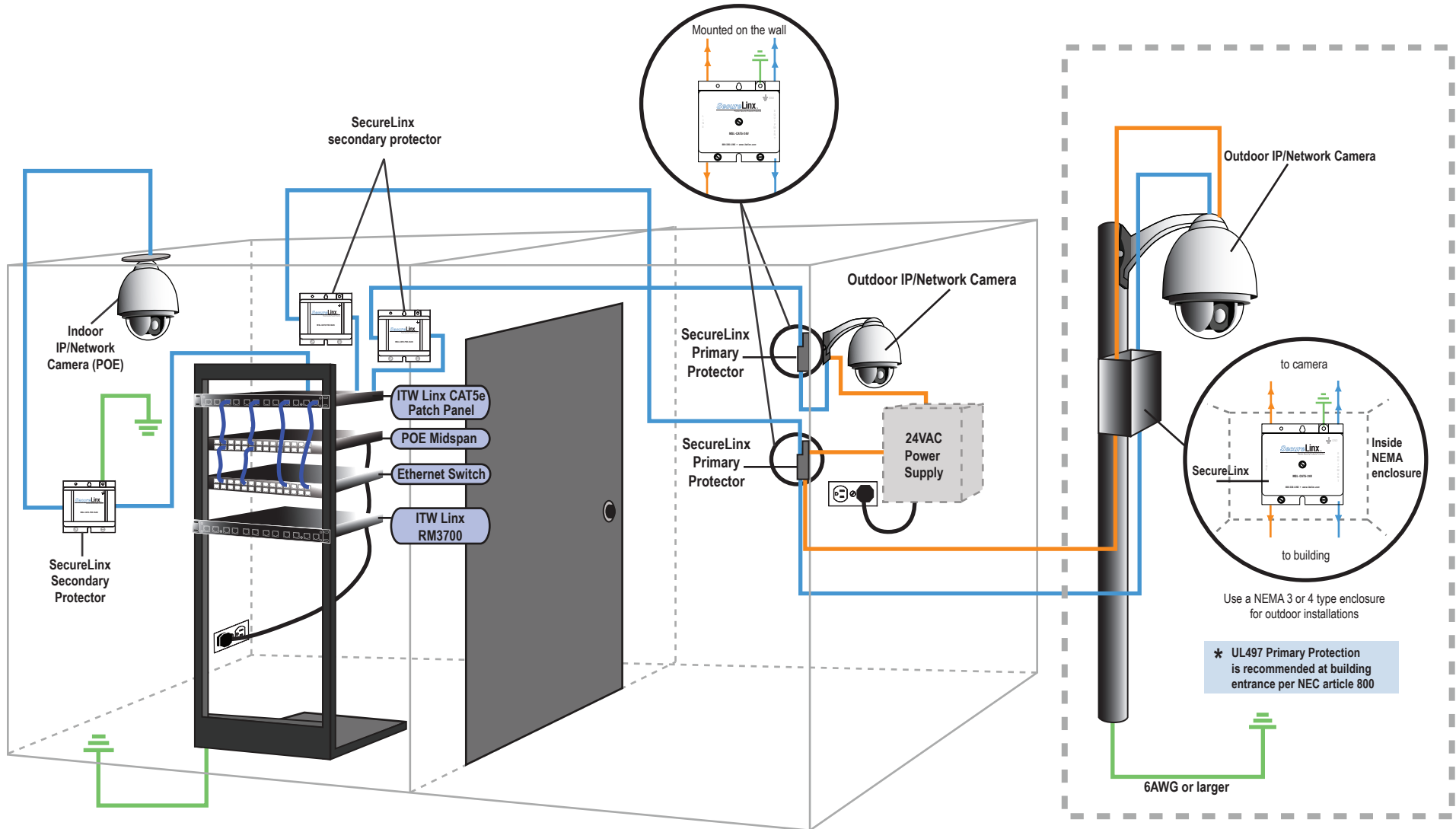

ITW LINX SURGE... PROTECTING YOUR INVESTMENTS



- △ Part of the outdoor camera enclosure housing
- ◇ As option : POE can be used to power camera - 24VAC used only to power heater/blower. Circuit board/splitter would not be used as in "Scenario 2".

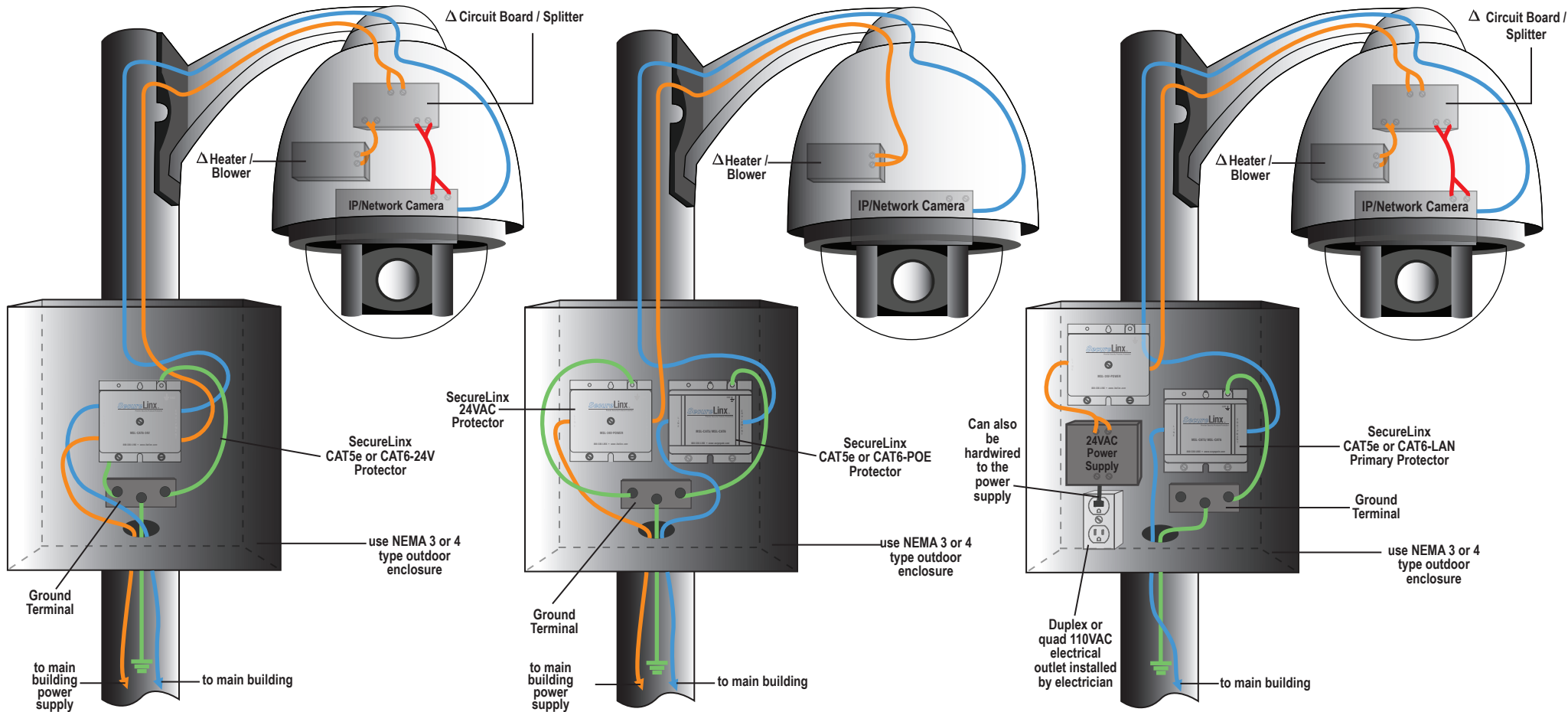

Scenario 1: Both camera and heater/blower in the camera housing are powered by a single run of 24VAC from the main building. (POE not used to power camera). Protect Ethernet and Power All in one.

Scenario 2:

- Camera powered by POE.
- Heater/blower powered by a single run of 24VAC from the main building (POE used to power camera)
- Protect Ethernet-POE and power separately

Scenario 3: Powering camera and heater/blower in outdoor camera housing when 110 VAC is available at the pole. Both camera and heater/blower are powered by 24VAC (◇POE not used at camera)